

Agenda



Delegated Decisions - Cabinet Member for Housing and Planning

Date: Thursday, 23 May 2024

To: Councillor J Clarke

Item

Wards Affected

1 Maesglas Public Space Protection Order (PSPO) (Pages 3 - 24)

Contact: Democratic Services
Tel: 06133 656656
E-mail: democratic.services@newport.gov.uk
Date of Issue: 16 May 2024

This page is intentionally left blank



Report

Cabinet Member for Strategic Planning, Regulation and Housing

Part 1

Date: 23 May 2024

Subject Maesglas PSPO

Purpose To ask the cabinet member to agree to public consultation for the plan to an extension of a Public Spaces Protection Order in the Maesglas area.

Author Public Protection Service Manager

Ward Gaer

Summary The cabinet member is asked to agree to public consultation for the plan to an extension of a Public Spaces Protection Order in the Maesglas area.

Proposal To carry out a public consultation to seek the views of stakeholders as to whether the current PSPO should be extended to cover the whole of the area shown edged red on the plan in Appendix B (Maesglas).

Action by Head of Environment and Public Protection

Timetable Immediate

This report was prepared after consultation with:

- Community Protection Manager
- Public Protection Services Manager
- Head of Finance
- Head of Law and Standards
- Head of People Policy and Transformation
- Antisocial Behaviour Liaison Team

Signed

Background

Definitions

The Antisocial Behaviour, Crime and Policing Act 2014, commenced in October 2014, and introduced the Public Spaces Protection Order (PSPO).

A PSPO is designed to prevent individuals or groups committing antisocial behaviour in a public space where the behaviour is having, or is likely to have, a detrimental effect on the quality of life of those in the locality; and the behaviour is or likely to be persistent or continuing in nature and be unreasonable.

The powers to make an Order rest with local authorities, in consultation with the Police, Police and Crime Commissioner and other relevant bodies who may be impacted upon by the Order.

The Council can make a PSPO on any public space within its own area. The definition of public space is wide and includes any place to which the public or any section of the public has access, on payment or otherwise, as of right or by virtue of express or implied permission, for example a shopping centre. The maximum length of a PSPO is three years, but it can be reviewed at any time.

When making a PSPO, the Council must have regard to the rights of freedom of expression and freedom of assembly and association set out in the Human Rights Act 1998.

Restrictions

A PSPO is intended to provide the Council and Police with additional powers to require individuals or groups to refrain from certain actions or to do certain things within specified times and within a clearly specified geographical location, to quote the Act "it can either be a blanket restriction or requirement or can be targeted against certain behaviours by certain groups at certain times".

Orders can be enforced by a Police Officer, Police Community Support Officer, and delegated Council officers. A breach of the Order is a criminal offence and can be dealt with through the issuing of a Fixed Penalty Notice of up to £100 (to be fixed locally), or a Level 2 or 3 fine (£500 or £1,000 depending on the specific offence), on prosecution. Due to the nature of the proposed restrictions, much of the enforcement is most likely to be carried out by police officers.

Considerations

In deciding to make a PSPO, the Council will need to consider a number of questions including.

- Is there a specific problem caused by activities?
- If so, what needs to be done to regulate or control the problem?
- What is the least restrictive way of achieving this?

Appeals

Anyone who lives in, or regularly works in or visits the area can appeal a PSPO in the High Court within six weeks of issue. Further appeal is available each time the PSPO is varied by the Council.

Maesglas PSPO

In September 2023, a PSPO was agreed by Council to cover an area in Maesglas, part of the Gaer electoral ward, to respond to antisocial behaviour. This included restricting access to a public path behind the shops situated on Cardiff Road and several other appropriate restrictions.

During consultation, consultees identified additional parts of the Maesglas area they felt would benefit from inclusion within the PSPO. At that time consideration was given to suspending the PSPO process and consulting further on a wider area. However, the decision was made to make the existing order, and then soon after commence a process of assessment of a widening of the PSPO area.

Officers have now reviewed complaints and incident data and believe there is sufficient evidence to inform a consultation with the public about the extension of the area. Officers across agencies have observed ASB and crime in the proposed extended area and are of the view that it would be beneficial to have the same restrictions in place for the wider "Maesglas" area. Meetings have been held with leaders within Gwent Police who have confirmed their desire to expand the area covered by such an order. It is therefore proposed that the boundary of the current PSPO (as shown in Appendix C) be amended so as to include the area shown in Appendix B. No other changes to the PSPO are proposed.

It is also proposed that the wording of the current PSPO be altered at clause 6e to clarify the location of the alternative route. The proposed new wording of the PSPO is set out at Appendix A.

The restrictions for the 2023 PSPO are:

Drinking Alcohol

"No person shall within the Restricted Area refuse to stop drinking alcohol or hand over any containers (sealed or unsealed) which are believed to contain alcohol, when required to do so by an authorised officer to prevent public nuisance or disorder".

- This restriction was previously in place for the successful 2018 PSPO and was requested to prevent the antisocial consumption of alcohol.

Causing Distress Etc.

No person shall behave (either individually or in a group) in a manner that causes or is likely to cause harassment, alarm or distress to a member of the public; persons who breach this prohibition shall, when ordered to do so by an authorised person, disperse immediately or by such time as may be specified and in a manner as may be specified by the said authorised person and failure to do so is a further breach of this Order.

- This restriction was previously in place for the successful 2018 PSPO and was requested to prevent the antisocial consumption of alcohol.

Intoxicating Substances

No person shall within the Restricted Area:

- a. Ingest, inhale, inject, smoke, possess or otherwise use intoxicating substances.
- b. Sell or supply intoxicating substances.

- c. Intoxicating substances (commonly referred to as “legal highs”) is given the following definition: substances with the capacity to stimulate or depress the central nervous system (does not include alcohol).
 - d. Exemptions shall apply in cases where the substances are used for valid and demonstrable medicinal use, given to an animal as a medicinal remedy, are cigarettes (tobacco) or vaporisers or are food stuffs (to include drinks) regulated by food health and safety legislation.
 - e. Persons who breach this prohibition shall surrender any such intoxicating substance in his/her possession when asked to do so by an authorised officer in the Restricted Area.
- This restriction was previously in place for the successful 2018 PSPO and was requested to prevent the possession and/or supply of drugs and other substances commonly known as “new psychoactive substances” or NLPs. It is identical to restrictions in Pill where a PSPO was enacted earlier this year. There is evidence of drug misuse in this area too.

Restricting Access to Lane

No person shall, except as provided in Articles (6c) and (6d) below, use the public right of way over the public place as shown coloured in blue on the Plan annexed to this Order hereafter referred to as (“the Restricted Area 2”); namely part of a lane that runs directly behind the shops located on Cardiff Road known locally as the “Maesglas shops”.

- a. Gates may be installed, operated, and maintained at each end by Newport City Council.
 - b. Any person using the gates referred to in Article (6a) to gain access to or from the Restricted Area 2 shall ensure that the gates are closed and locked immediately after they are used.
 - c. The restriction in Article (6) of this Order shall not apply to any person who occupies premises adjoining or adjacent to the Restricted Area 2.
 - d. The restrictions in Articles (6) and (6b) of this Order shall not apply to any Police, Ambulance or Fire Service personnel acting in pursuance of statutory powers or duties or to any statutory undertakers, gas, electricity, water, or communications provider requiring access to their apparatus situated in the Restricted Area 2.
 - e. The alternative route for pedestrians is as shown in yellow on the Plan annexed to this Order.
 - f. No waste or household item shall be deposited, stored, or discarded in the Restricted Area 2. This restriction shall not apply to any wheeled bin or other approved receptacle for the storage of waste where the Council has given written consent for the wheeled bin or approved receptacle to be stored in the Restricted Area 2.
- To the rear of the Maesglas Shops there is a path which allows the public to gain access to the shops, a community centre, and houses.
 - The path was used frequently by groups of people to congregate, with drug possession/abuse taking place together with other forms of antisocial behaviour, including intimidation of nearby residents. The path was also used by groups of youths to disperse after causing problems on surrounding streets. The path allows foot access by some of the retailers located at the Maesglas Avenue end of the row of shops, into the rear of their businesses. The remainder of the area behind the shops was fenced off some years ago and those premises can only be accessed from Bideford Road.
 - It is proposed to gate the path and for the gates to be always closed unless required for access. The positions of the proposed gates are shown on the map included at Appendix 2.
 - An alternative route exists around the front of the shops on Cardiff Road, or along Maesglas Avenue and into the lane at the rear of Maesglas Avenue, accessed by turning into the road between 71 and 73 Maesglas Avenue.

- Each of the retailers affected are provided with a key to allow them legitimate access to the path, should this be required.

These are the restrictions that will be included in the proposed extension request and are to be included in the 2024 consultation. The form of the proposed consultation is set out at Appendix D.

Financial Summary (Capital and Revenue)

There are no costs required beyond existing provision.

	Year 1 (Current) £	Year 2 £	Year 3 £	Ongoing £	Notes including budgets heads affected
Costs (Income)	0	0	0	0	
Net Costs (Savings)					
Net Impact on Budget					

Risks

Risk Title / Description	Risk Impact score of Risk if it occurs* (H/M/L)	Risk Probability of risk occurring (H/M/L)	Risk Mitigation Action(s) What is the Council doing or what has it done to avoid the risk or reduce its effect?	Risk Owner Officer(s) responsible for dealing with the risk?
ASB and crime grows in the area.	H	H	Agree to consult.	Public Protection Services Manager
Community feels isolated.	H	H	Agree to consult.	Public Protection Services Manager
Council puts in measures that are disproportionate to the problems experienced and are open to legal challenge.	M	L	The previous order had restrictions that worked well, and consultation has been carried out and delivered significant numbers of responses. The vast majority of replies have been supportive.	Public Protection Services Manager

Links to Council Policies and Priorities

The maintenance of such a PSPO in this key residential area also supports Safer Newport, the area's Community Safety Partnership, which has a commitment to reduced antisocial behaviour and crime in the city.

The council's corporate plan shows a commitment to the economy, education, and skills within its well-being objective of delivering a Newport that is thriving and growing and aspiring to provide opportunities to all. This PSPO fits well with this objective as it seeks to provide businesses in Newport with an improved trading environment free of antisocial behaviour. This PSPO supports the bank of shops on Cardiff Road and provides the message that the partners support their businesses.

Options Available and considered.

1. Agree to the consultation.
2. Decide against consultation.

Preferred Option and Why

1. Agree to the consultation. The intelligence supports further action, it seems further controls will lead to improved community safety, it seems the community will support this, and the previous PSPO was successful.

Comments of Chief Financial Officer

There are no reported financial implications from this proposed PSPO consultation, and any periodic costs of monitoring/applying the restrictions will be afforded from existing resources.

Comments of Monitoring Officer

A local authority may vary a PSPO to extend the boundary of the area covered by the order. To do so, the authority must be satisfied that the enlarged area meets the statutory tests for the grant of a PSPO, including that the activities carried on in that area are having a detrimental effect on the quality of life of those in that locality or it is likely that such activities will be carried on. The activities must be, or must likely be, of a continuing nature, unreasonable and sufficient to justify the restrictions imposed by the order. The proposed consultation should enable the Council to determine whether the proposed changes to the existing PSPO are justifiable in accordance with the above. The proposed variation would, if adopted, vary the PSPO for the remainder of the duration of the order (subject to any future variations). The Council must comply with the statutory publication requirements in relation to any revised order.

Comments of Head of People, Policy, and Transformation

In 2018 a Public Spaces Protection Order was put in place to cover parts of Maesglas, as a response to concerns about antisocial behaviour. This included restricting access to a public path situated to the rear of Cardiff Road and other restrictions to curb antisocial behaviour. Following discussions with local ward members, Gwent Police and Newport City Homes the PSPO was reinstated in September 2023. Council officers have reviewed complaints and incident data and believe there is sufficient evidence to justify consulting with the public about extending the PSPO to cover the wider "Maesglas" area. Judicious use of PSPOs demonstrates a joined-up and preventative response to ASB and builds engagement and cooperation with communities.

Comments of Non-Executive Members

Councillor Marshall:

Can I ask that the map question is reviewed as it is confusing as it stands. Can it be a tick box showing current, potential enlargement/ expansion and other please state.

Other than that happy and pleased to see it coming in through council

Councillor Perkins:

Thank you for the information and attached survey. I echo Councillor Marshall's point as to the question about the size of the area, the map shown shows the increased area, the question implies that it may be further increased.

Will be very happy for this to go through council and be implemented on the increased area as shown.

Response:

We are fine with changing the map and adding the tick box.

Scrutiny Committees

N/A

Fairness and Equality Impact Assessment:

- Wellbeing of Future Generation (Wales) Act
- Equality Act 2010
- Socio-economic Duty
- Welsh Language (Wales) Measure 2011

No Equalities Impact Assessment is necessary in this case as the proposals set out in this report have no more impact on those with protected characteristics than any other group or individual.

- The proposals set out in this report have no more impact on children or families than any other group or individual.
- The proposals set out in the report to be consulted on would contribute to several the Well-being Goals set out in the Wellbeing of Future Generations (Wales) Act 2015. Relevant goals are “A more equal Wales”, “A Wales of cohesive communities”, “A Wales of vibrant culture and thriving Welsh language”.
- The proposal takes account of the sustainable development principle. The proposals would contribute by helping to prevent problems of antisocial behaviour blighting the area, which would help to build a cohesive and sustainable community.
- A successful consultation took place is in line with the requirement to involve people in decisions that affect them. The public were very engaged with the process and have supported the reintroduction of the order.

Crime and Disorder Act 1998

Section 17(1) of the Crime and Disorder Act 1998 imposes a duty on the Local Authority to exercise its various functions with due regard to the likely effect of the exercise of those functions on, and the need to do all that it reasonably can to prevent, crime and disorder in its area.

This PSPO will enhance the work being done in the city to prevent, crime and disorder in the area.

Consultation

Consultation took place in August/September 2023. Details are referenced above.

Background Papers/Appendix

- A. Proposed Renewed Order
- B. Map x2 of PSPO Proposed 2024
- C. Map x2 of PSPO Actual 2023
- D. Consultation Questions

Dated: 23 May 2024

Appendix A: Proposed Renewed Order

ANTI-SOCIAL BEHAVIOUR, CRIME AND POLICING ACT 2014 SECTION 59 PUBLIC SPACES PROTECTION ORDER 2018 MAESGLAS, NEWPORT

NEWPORT CITY COUNCIL in exercise of its powers under Section 59 of the Anti-Social Behaviour, Crime and Policing Act 2014 (“the Act”) hereby makes this Order, being satisfied on reasonable grounds that activities in a public space, namely in the MAESGLAS area of Newport, have had or are likely to have a detrimental effect on the quality of life of those in the locality and that these activities involved various anti-social behaviours. Further, Newport City Council believes that the effect, or likely effect, of the said activities is, or is likely to be, persistent or continuing in nature, such as to make the activities unreasonable and justifies the restrictions imposed by this Order:-

1. This Order shall come into operation on _____ 2018 and shall have effect for a period of 3 years thereafter, unless extended by further Orders under the Council’s statutory powers.
2. This Order relates to the public place in the City of Newport as shown edged in red on the Plan annexed to this Order (“the Restricted Area”) commonly referred to as “MAESGLAS”.

PROHIBITIONS:-

3. No person shall within the Restricted Area refuse to stop drinking alcohol or hand over any containers (sealed or unsealed) which are believed to contain alcohol, when required to do so by an authorised officer to prevent public nuisance or disorder.
4. No person shall behave (either individually or in a group) in a manner that causes or is likely to cause harassment, alarm or distress to a member of the public; persons who breach this prohibition shall, when ordered to do so by an authorised person, disperse immediately or by such time as may be specified and in a manner as may be specified by the said authorised person and failure to do so is a further breach of this Order.
5. No person shall within the Restricted Area:
 - a. Ingest, inhale, inject, smoke, possess or otherwise use intoxicating substances.
 - b. Sell or supply intoxicating substances.
 - c. Intoxicating substances (commonly referred to as “legal highs”) is given the following definition: substances with the capacity to stimulate or depress the central nervous system (does not include alcohol).
 - d. Exemptions shall apply in cases where the substances are used for valid and demonstrable medicinal use, given to an animal as a medicinal remedy, are cigarettes (tobacco) or vaporisers or are food stuffs (to include drinks) regulated by food health and safety legislation.
 - e. Persons who breach this prohibition shall surrender any such intoxicating substance in his/her possession when asked to do so by an authorised officer in the Restricted Area.
6. No person shall, except as provided in Articles (6c) and (6d) below, use the public right of way over the public place as shown coloured in blue on the Plan annexed to this Order hereafter referred to as (“the Restricted Area 2”); namely part of a lane that

runs directly behind the shops located on Cardiff Road known locally as the "Maesglas shops".

- a. Gates may be installed, operated and maintained at each end by Newport City Council.
- b. Any person using the gates referred to in Article (6a) to gain access to or from the Restricted Area 2 shall ensure that the gates are closed and locked immediately after they are used.
- c. The restriction in Article (6) of this Order shall not apply to any person who occupies premises adjoining or adjacent to the Restricted Area 2.
- d. The restrictions in Articles (6) and (6b) of this Order shall not apply to any Police, Ambulance or Fire Service personnel acting in pursuance of statutory powers or duties or to any statutory undertakers, gas, electricity, water or communications provider requiring access to their apparatus situated in the Restricted Area 2.
- e. The alternative route for pedestrians is the public footpath, highlight in amber..
- f. No waste or household item shall be deposited, stored, or discarded in the Restricted Area 2. This restriction shall not apply to any wheeled bin or other approved receptacle for the storage of waste where the Council has given written consent for the wheeled bin or approved receptacle to be stored in the Restricted Area 2.

FIXED PENALTY NOTICES AND OFFENCES:-

7. It is an offence for a person without reasonable excuse to engage in any activity that is prohibited by this Order.
8. In accordance with section 63 of the Act, a person found to be in breach of this Order by consuming alcohol or by refusing to surrender alcohol to an authorised person is liable on summary conviction to a maximum penalty of a Level 2 fine (currently £500) or to a Fixed Penalty Notice up to £100.
9. In accordance with section 67 of the Act, a person found to be in breach of this Order other than by consuming alcohol or by refusing to surrender alcohol to an authorised person is liable on summary conviction to a maximum penalty of a Level 3 fine (currently £1000) or to a Fixed Penalty Notice up to £100.

APPEALS:-

10. If any interested person wishes to question the validity of this Order on the grounds that the Council had no power to make it or that any requirement of the Act has not been complied with in relation to this Order, he or she may apply to the High Court within 6 weeks from the

date on which this Order is made.

Dated:
THE COMMON SEAL of)
NEWPORT CITY COUNCIL was)
here unto affixed in the presence of:-)
)

Appendix B: Map of Proposed PSPO 2024

Restricted Area 1

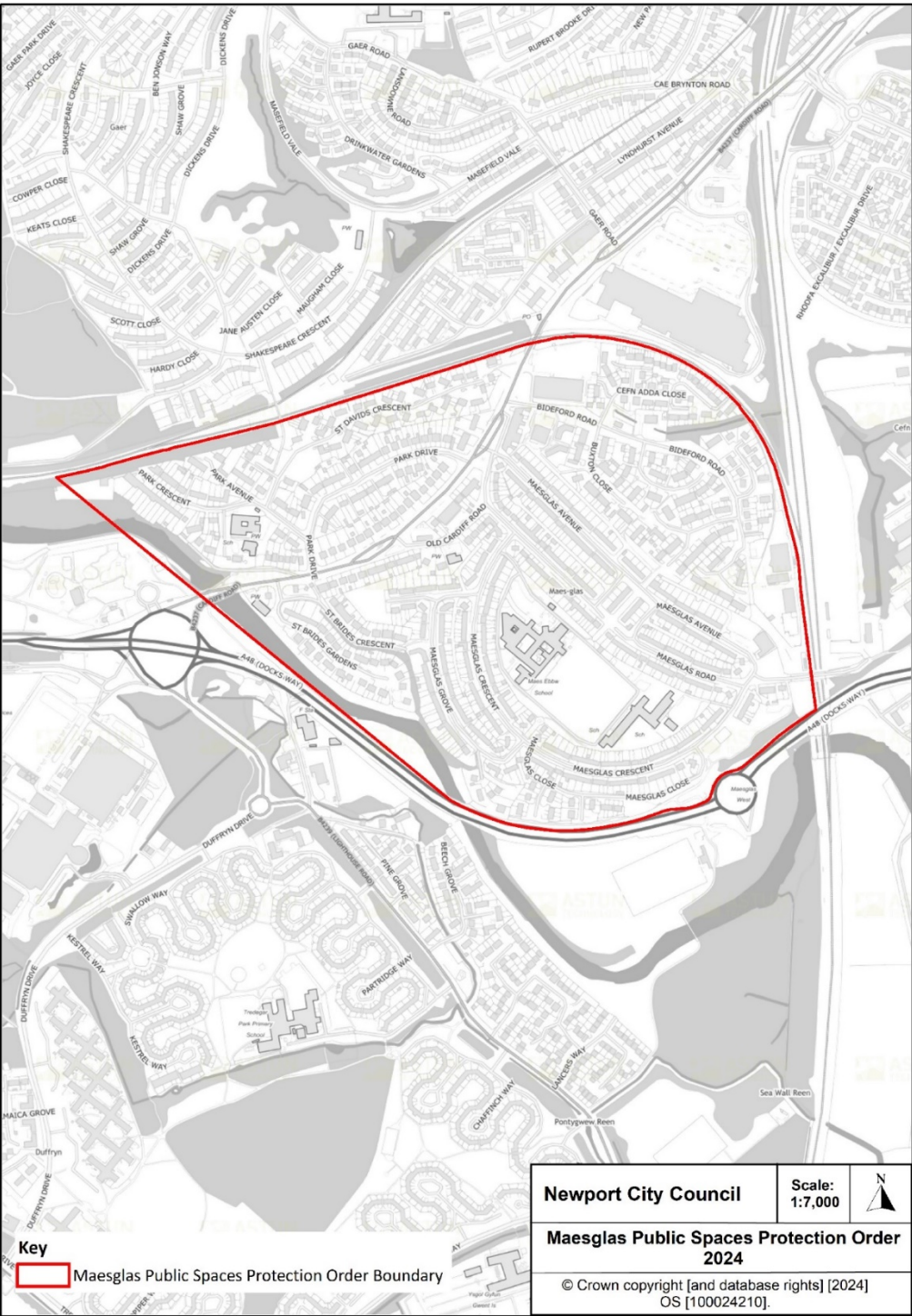

Restricted Area 2

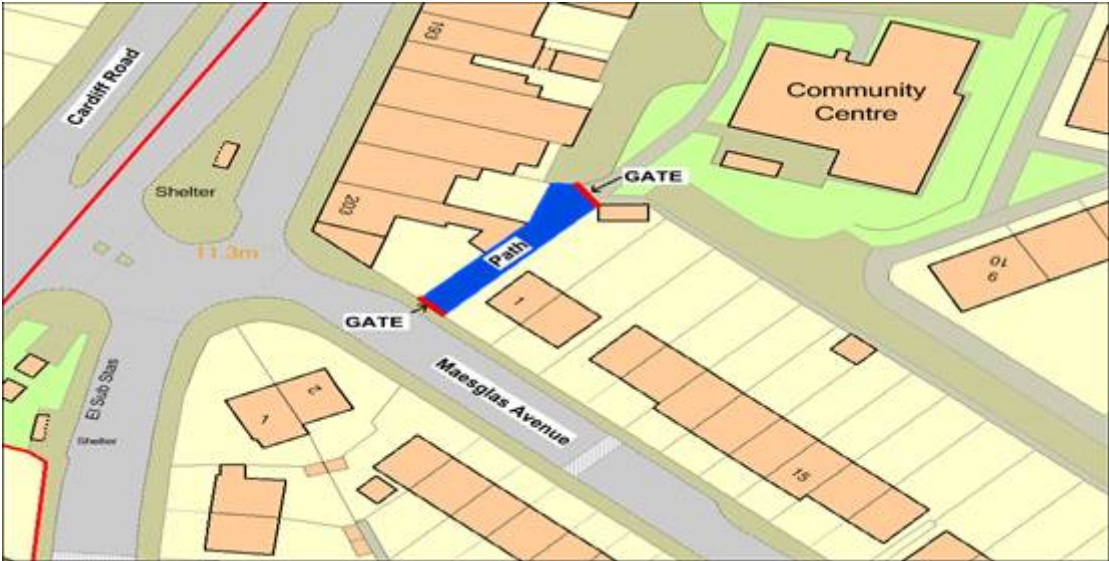

Appendix C: Map of PSPO 2023

Restricted Area 1

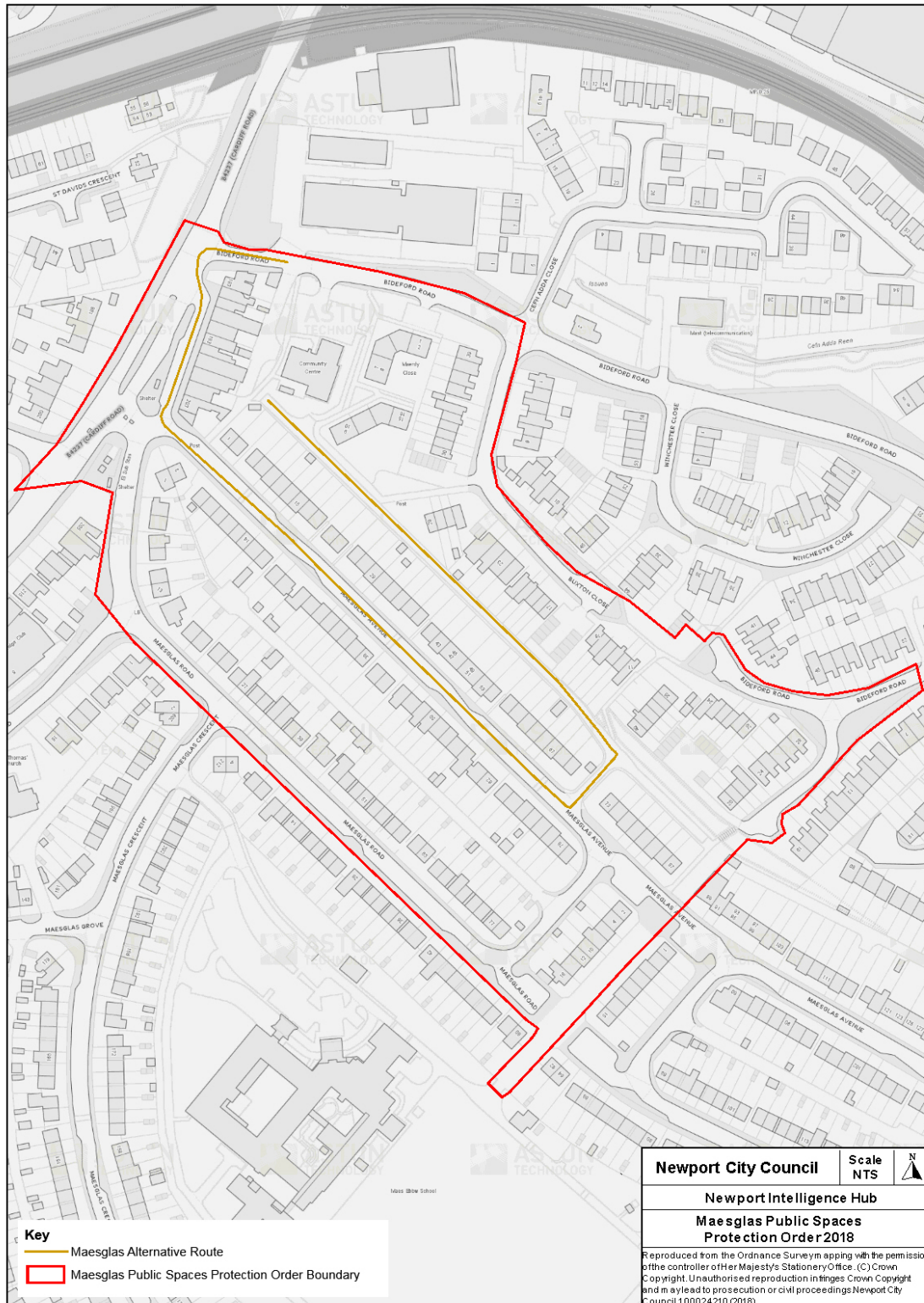

Restricted Area 2

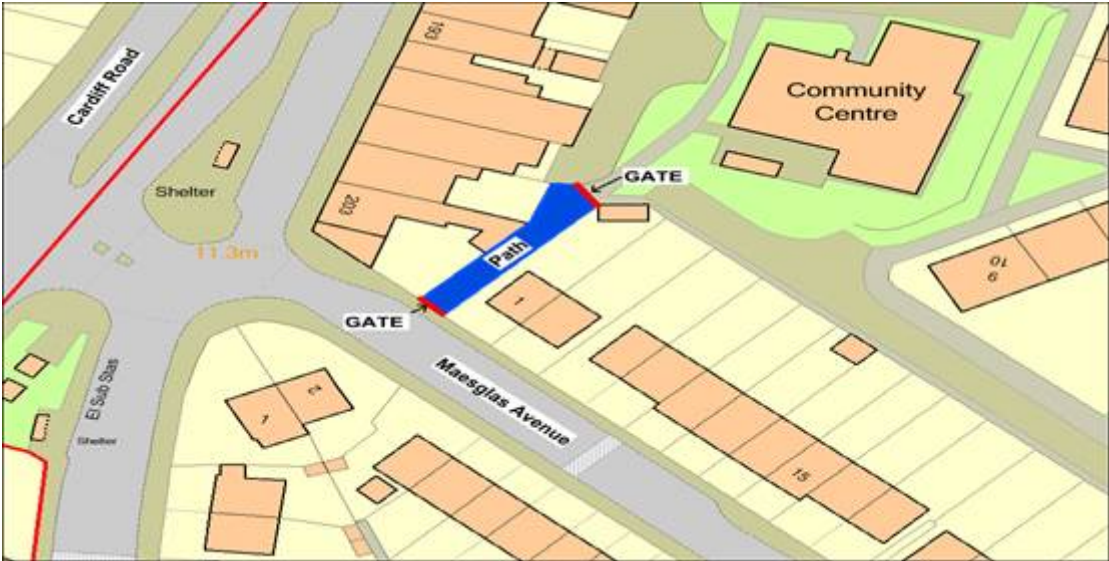

APPENDIX D



Public Space Protection Order (PSPO) Extension– Maesglas

What is a Public Space Protection Order (PSPO)?

The Anti-social Behaviour, Crime and Policing Act 2014 provides a broad legal framework within which PSPOs can be implemented. Orders can be introduced in a specific public area where the local authority is satisfied on reasonable grounds that certain conditions have been met.

1.	Are you a.....?	
	<input type="checkbox"/> Resident of Maesglas	<input type="checkbox"/> Visitor to Maesglas
	<input type="checkbox"/> Worker in Maesglas	<input type="checkbox"/> Other (please specify)
Please specify:		
2.	Have you been affected by or witnessed Anti-Social Behaviour recently that would be affected by the proposed restrictions.	
	<input type="checkbox"/> Never	<input type="checkbox"/> Rarely
2.a	What type of Anti-Social Behaviour? Tick all that apply	
	<input type="checkbox"/> Groups or Gatherings of people	<input type="checkbox"/> Littering
	<input type="checkbox"/> Drinking alcohol on the streets	<input type="checkbox"/> Drug use, dealing or finding drug paraphernalia
	<input type="checkbox"/> Aggressive or intimidating begging	<input type="checkbox"/> Aggressive or dangerous use of push bikes
	<input type="checkbox"/> Verbal Harassment	<input type="checkbox"/> Aggressive or dangerous use of E-scooters and E-bikes
	<input type="checkbox"/> Urination or defecation on the street	<input type="checkbox"/> Other (please specify)
	Please specify:	
3.	It is proposed that the the 2023 Public Spaces Protection Order boundary is extended as part of the conditions of the original order. Please select if you agree or disagree with each restriction being included in a new Order.	
	<input type="checkbox"/> Agree	<input type="checkbox"/> Disagree
	If you disagree, please state your reasons?	

The conditions in the Public Space Protection Order are as follows, please select if you agree or disagree. If you are disagreeing, please state your reasons.

In red could be taken out?

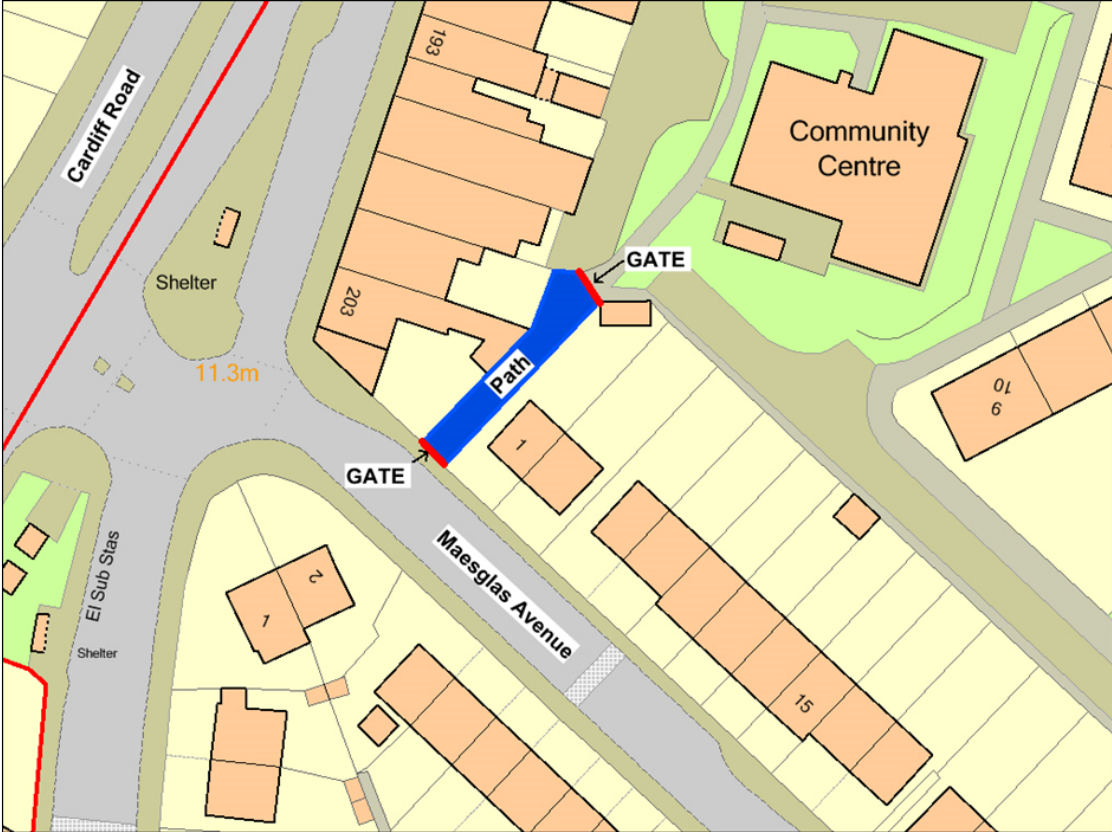
4.a	<p>A Gating Order is in place to restrict access to the rear lane of the Maesglas Shops that will prevent any access through that lane. The below image shows the proposed position of the gate to close the path:</p>  <p>Subject to funding and key holders being available.</p> <p><input type="checkbox"/> Agree <input type="checkbox"/> Disagree</p> <p>If you disagree, why?</p>
4.b	<p>If it was possible to install CCTV to cover the rear of the lane, would you be supportive?</p> <p><input type="checkbox"/> Yes <input type="checkbox"/> No</p>
4.c	<p>Please add any further comments about this condition.</p>
5.a	<p>A person is not to loiter or congregate in a street or public place and use intimidating or threatening behaviour towards members of the public, cause a nuisance or other antisocial behaviour.</p> <p><input type="checkbox"/> Agree <input type="checkbox"/> Disagree</p> <p>If you disagree, why?</p>
5.b	<p>Have you been affected by / witness to this type of behaviour in Maesglas recently?</p> <p><input type="checkbox"/> Yes <input type="checkbox"/> No</p>
6.a	<p>Drinking in a public place being restricted – No person shall within the Restricted Area refuse to stop drinking alcohol or hand over any containers (sealed or unsealed) which are believed to contain alcohol, when required to do so by an authorised officer to prevent public nuisance or disorder.</p> <p><input type="checkbox"/> Agree <input type="checkbox"/> Disagree</p>

	If you disagree, why?
6.b	Have you been affected by / witness to this type of behaviour in Maesglas recently? <input type="checkbox"/> Yes <input checked="" type="checkbox"/> No
7.a	Possession of controlled substances – A person is prohibited from having in their possession, selling or supplying any intoxicating substance namely any substance with the capacity to stimulate or depress the central nervous system but does not include alcohol, tobacco or vaporisers; a person is required to surrender any such intoxicating substances in his/her possession when asked to do so by an authorised officer in the Restricted Area. A person does not commit an offence under this Order where the said substance is used for a valid medicinal use. <input type="checkbox"/> Agree <input checked="" type="checkbox"/> Disagree If you disagree, why?
7.b	Have you been affected by / witness to this type of behaviour in Maesglas recently? <input type="checkbox"/> Yes <input checked="" type="checkbox"/> No
8.	Is there anything else you would like to see included in the Order? <input type="checkbox"/> Yes <input checked="" type="checkbox"/> No Please state:

9. The map 1 shows the current boundary of the area covered by the PSPO (shown by the red line). It is proposed to extend the area (map 2) Do you think this proposed extension area includes the correct streets and areas? If not, do you think the area should be bigger or smaller? Please give reasons for your answer.

(1)

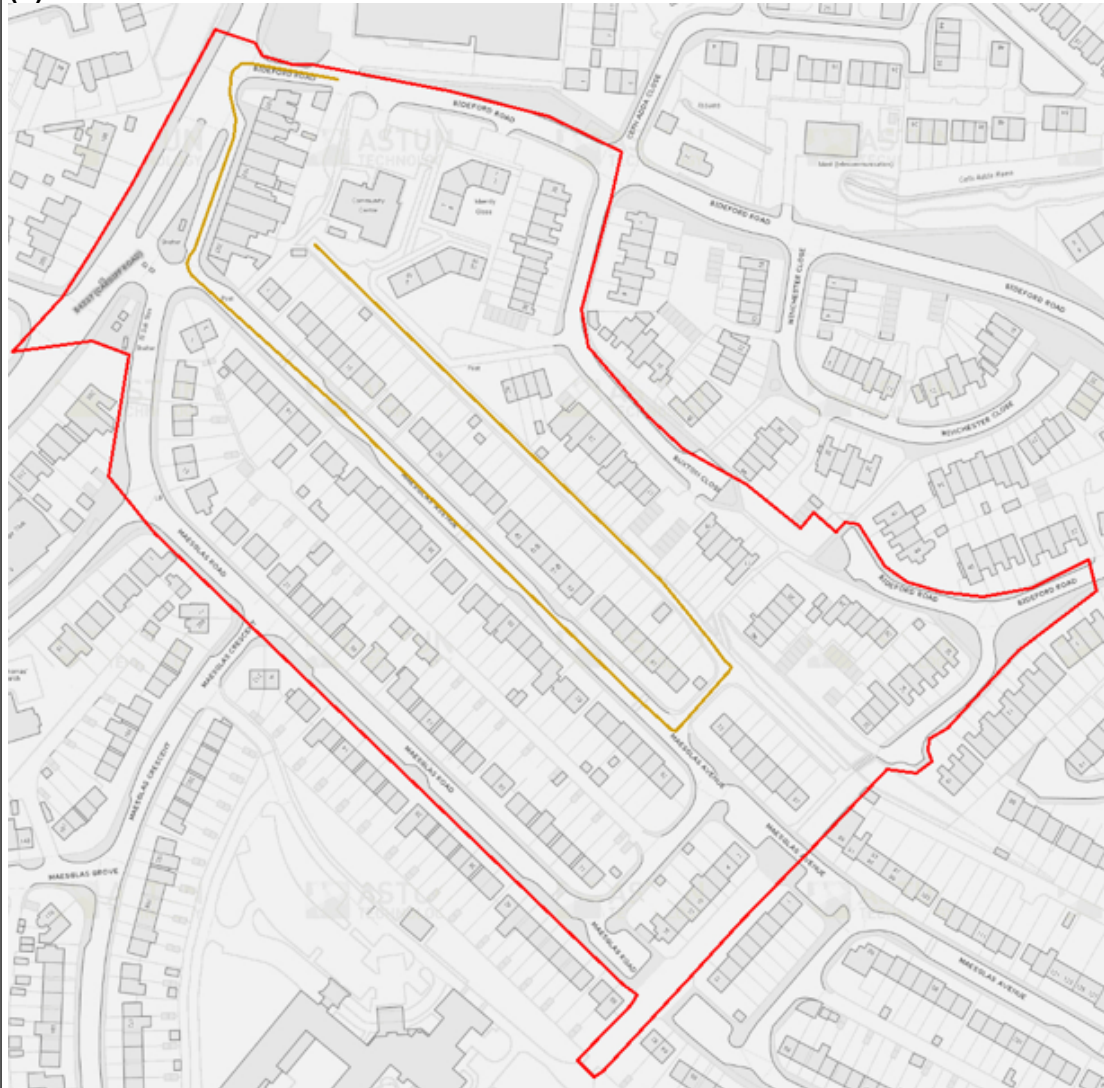

(2)



What do you think we should do (tick your preference)?

Keep to the Maesglas boundary
 Make bigger
 Make smaller

If you have ticked 'make bigger' or 'make smaller', please give details and specify the streets / areas you feel should be included or excluded:

Equalities Monitoring

This is to gather more comprehensive equalities information for those completing the survey.

10.	What is your gender?		
	<input type="checkbox"/> Male	<input type="checkbox"/> Non-binary	<input type="checkbox"/> Prefer not to say
	<input type="checkbox"/> Female	<input type="checkbox"/> Self-identify	
If you ticked 'Self-identify', please state:			
11.	Age?		
	<input type="checkbox"/> Under 18 years old	<input type="checkbox"/> 35-44 years old	<input type="checkbox"/> 65-74 years old
	<input type="checkbox"/> 18-24 years old	<input type="checkbox"/> 45-54 years old	<input type="checkbox"/> 75 years or older
	<input type="checkbox"/> 25-34 years old	<input type="checkbox"/> 55-64 years old	<input type="checkbox"/> Prefer not to say
12.	What area of Newport do you live in?		
	<input type="checkbox"/> Allt-Yr-Yn	<input type="checkbox"/> Pillgwenlly	
	<input type="checkbox"/> Alway	<input type="checkbox"/> Ringland	
	<input type="checkbox"/> Beechwood	<input type="checkbox"/> Rogerstone East	
	<input type="checkbox"/> Bettws	<input type="checkbox"/> Rogerstone North	
	<input type="checkbox"/> Bishton and Langstone	<input type="checkbox"/> Rogerstone West	
	<input type="checkbox"/> Caerleon	<input type="checkbox"/> Shaftesbury (Crindau / Brynglas)	
	<input type="checkbox"/> Gaer	<input type="checkbox"/> St Julians	
	<input type="checkbox"/> Graig	<input type="checkbox"/> Stow Hill	
	<input type="checkbox"/> Llanwern (Goldcliff)	<input type="checkbox"/> Tredegar Park and Marshfield (Duffryn)	
	<input type="checkbox"/> Lliswerry	<input type="checkbox"/> Victoria (Maindee)	
	<input type="checkbox"/> Malpas	<input type="checkbox"/> I do not live in Newport	
	13.	Do you consider yourself to be disabled?	
<input type="checkbox"/> Yes		<input type="checkbox"/> No	<input type="checkbox"/> Prefer not to say
14.	Do you consider yourself a Welsh speaker?		
	<input type="checkbox"/> Yes – Fluent	<input type="checkbox"/> No	
	<input type="checkbox"/> Yes – able to understand some Welsh	<input type="checkbox"/> Prefer not to say	
15.	What is your ethnic group?		
	<input type="checkbox"/> White – Welsh / English / Scottish / Northern Irish / British		
	<input type="checkbox"/> White Irish	<input type="checkbox"/> Gypsy or Irish Traveller	
	<input type="checkbox"/> Roma	<input type="checkbox"/> Any other White background (please state):	
	<input type="checkbox"/> White & Black Caribbean	<input type="checkbox"/> White & Asian	
	<input type="checkbox"/> White & Black African		
	<input type="checkbox"/> Any other mixed or multiple ethnic background (please state):		
	<input type="checkbox"/> Indian	<input type="checkbox"/> Pakistani	
	<input type="checkbox"/> Bangladeshi	<input type="checkbox"/> Chinese	
	<input type="checkbox"/> Any other Asian, Asian Welsh or Asian British (please state):		
	<input type="checkbox"/> Black African	<input type="checkbox"/> Black Caribbean	
	<input type="checkbox"/> Any other Black, Black Welsh or Black British background (please state):		

	<input type="checkbox"/> Arab		
	<input type="checkbox"/> Any other ethnic group or background (please state):		
	<input type="checkbox"/> Prefer not to say		
16.	What is your current sexual orientation?		
	<input type="checkbox"/> Heterosexual / Straight		<input type="checkbox"/> Pansexual
	<input type="checkbox"/> Gay man / Homosexual		<input type="checkbox"/> Asexual / ACE
	<input type="checkbox"/> Gay woman / Lesbian		<input type="checkbox"/> Other sexual orientation (please state)
	<input type="checkbox"/> Bisexual		<input type="checkbox"/> Prefer not to say
	Other sexual orientation (please state):		
17.	Are you married or in a civil partnership?		
	<input type="checkbox"/> Yes	<input type="checkbox"/> No	<input type="checkbox"/> Prefer not to say
18.	Religion / Belief?		
	<input type="checkbox"/> Buddhist	<input type="checkbox"/> Muslim	<input type="checkbox"/> No religion
	<input type="checkbox"/> Christian (all denominations)	<input type="checkbox"/> Sikh	<input type="checkbox"/> Agnostic
	<input type="checkbox"/> Hindu	<input type="checkbox"/> Any Other	<input type="checkbox"/> Humanist
	<input type="checkbox"/> Jewish	<input type="checkbox"/> Atheist	<input type="checkbox"/> Prefer not to say
19.	What is your sex?		
	<input type="checkbox"/> Female	<input type="checkbox"/> Male	<input type="checkbox"/> Prefer not to say
20.	Is your gender identity the same as the sex assigned to you at birth?		
	<i>Gender identity is a way to describe how you feel about your gender. Some people know/feel that their gender identity is the same as the sex that they were assigned at birth – for example, a person whose original birth certificate says ‘male’ and they identify as a man (‘yes’ to this question). Some people know/feel that their gender identity is not the same as the sex they were assigned at birth – for example, a person whose original birth certificate says ‘male’ and they identify as a woman (‘no’ to this question).</i>		
	<input type="checkbox"/> Yes	<input type="checkbox"/> No (please state, gender identity)	<input type="checkbox"/> Prefer not to say
	Please state, gender identity:		
21.	Caring Responsibilities		
	A: Do you care for children of school age?		
	<input type="checkbox"/> Yes	<input type="checkbox"/> No	<input type="checkbox"/> Prefer not to say
	B: Do you care for children of pre-school age?		
	<input type="checkbox"/> Yes	<input type="checkbox"/> No	<input type="checkbox"/> Prefer not to say
	C: Do you care for a dependent adult or child above school age?		
	<input type="checkbox"/> Yes	<input type="checkbox"/> No	<input type="checkbox"/> Prefer not to say

Thank you for taking the time to comment on the PSPO.